

Partner Update

Number of Clients Enrolled: 1,790

Days Until Grant Ends: 1,004 (December 31, 2020)

Alameda Medical Respite and Wellness Center

A new medical center to address health and housing needs with an emphasis on serving seniors, persons experiencing homelessness, and residents with medical and mental health challenges is planned in the City of Alameda. The Alameda Point Collaborative and Project Partners received conditional approval from the U.S. Department of Health and Human Services to develop and transform a 3.65 acre former Army Base adjacent to Alameda's Crab Cove into a medical respite and wellness center. The center will serve people experiencing homelessness in Alameda County with emphasis on serving seniors, persons with medical and mental health challenges and high users of the health care system.



Alameda Respite and Wellness Center Open House



Open House on February 13, 2018

The proposed adaptive-reuse of the expansive site is planned for 80-90 units of permanent supportive housing, a 50-bed medical respite program, a Federally Qualified Health Clinic for medical and behavioral health care, and a Resource Center and Coordinated Entry hub. The overarching framework will integrate trauma-informed, culturally responsive and recovery-oriented care. The wellness center can also benefit from healing methods such as art, community gardening, yoga, acupuncture, and a walking trail.

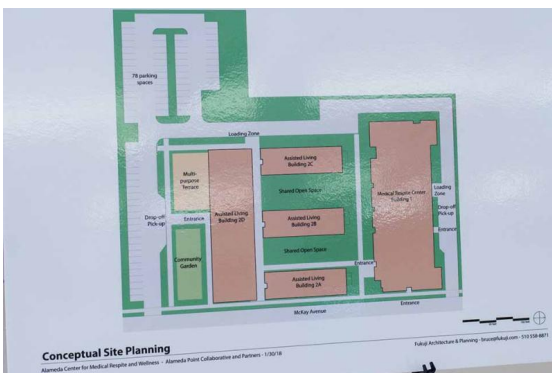



The project will be guided by an Advisory Group comprised of community, health care, public agency, and nonprofit representatives that will begin meeting in Spring and Summer 2018. The facility is slated to be operational by Fall 2020.

For more information contact Bonnie Wolf, Project Manager, at bonniewolf@att.net.

Housing Support Services

Alameda County Care Connect has been working with countywide partners to implement Coordinated Entry in Alameda County since Fall 2017. Coordinated Entry is the front door to the Housing Crisis Response System, Alameda County's overall system of services and housing programs that are coordinated to end homelessness and respond to this unprecedented housing crisis. The purpose of Coordinated Entry is to prevent or end homelessness for anyone experiencing a housing crisis by using a responsive, accessible, standard, fair, and equitable process. Offered through a network of countywide access points, Coordinated Entry serves people who are currently homeless and those at risk of homelessness in Alameda County. People in need of housing services and programs can call 2-1-1 as the first step in Coordinated Entry or visit EveryOneHome.org.

Housing Navigation Services - Housing Resource Centers (HRCs) provide housing navigation as part of the Housing Crisis Response System. Housing navigators serve as advocates for those experiencing homelessness throughout the housing search process and provide a range of housing services that include support with tenant screening and assessment, developing a housing support plan, connecting clients to resources such as health care services, and supporting clients in applying for public benefits.

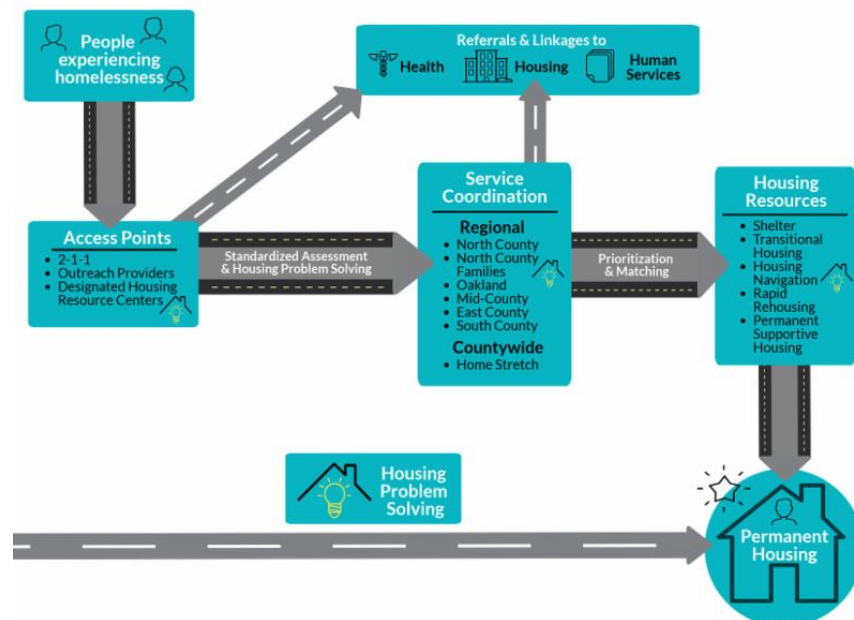

There are also a range of housing resources that are available and free to the public regardless of housing status. These resources include:

- Housing workshops (www.bayareacs.org)
- Legal consultation and housing legal workshops (www.baylegal.org)

For more information, visit www.accareconnect.org.

Homeless Management Information System

In conjunction with Housing and Community Development (HCD) and EveryOne Home, Alameda County Care Connect is implementing a new Homeless Management Information System (HMIS) across the County. This system will support the Housing Crisis Response System and Coordinated Entry services for homeless by providing key functions such as assessment, prioritization, and matching to resources. In February and March 2018, Health Care Services Agency (HCSA) of Alameda County, EveryOne Home, and the Housing and Community Development Department continue to discuss HMIS project configuration, a key component in the implementation process.

Housing Resource Centers (HRCs) continue to use the new prioritization assessment tools to assess individuals in the Housing Crisis Response System. Each region has focused on assessment of clients who are high need individuals, who may be in existing programs such as shelters and transitional housing, and who are engaged through street outreach by our partners. As of the first week of March, 1,532 unique persons have been assessed and entered into HMIS as shown in the figure below.

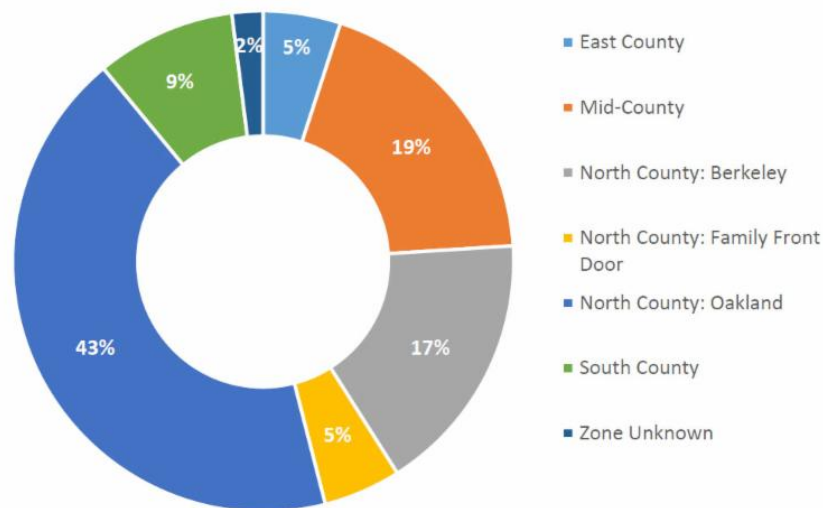

Number of Assessments by Region Completed through March

Keys to Success Using a Coordinated Response to Address Homelessness

There are currently over 5,600 homeless people in Alameda County, many of which are in need of medical, mental health, and housing navigation services. There are a variety of outreach efforts whose aim is to provide medical, mental health, housing and harm reduction services to unsheltered people in our community. However, they often work in silos, causing lack of coordinated care, inefficiencies, and missed opportunities for moving people indoors. Furthermore, best practices of homeless outreach in similar geographic regions include one full time outreach worker for every 140 homeless individuals. Alameda County currently only has 18 full-time staff dedicated to homeless outreach. That means one staff member has over 300 cases at any given time!

Healthcare for the Homeless and Alameda County Care Connect have partnered to develop next steps

to create more coordinated homeless response and outreach in recognition of the need for system-wide strategic changes to better serve homeless people. This effort is grounded in a housing first approach, which aims to quickly connect people experiencing homelessness to housing without common preconditions and barriers to entry such as sobriety or specific service requirements.

Outreach

First, we must expand the workforce and provide ongoing training and support in order to build effective street outreach teams throughout the County and ensure that every unsheltered person in Alameda County is connected to an outreach provider. Effective street outreach should entail coordination among all providers within each jurisdiction and emphasize relationship building and meeting the client where they are based, with the end goal of moving people indoors in mind.

Healthcare for the Homeless and Care Connect

Healthcare for the Homeless and Care Connect are committed to fostering strategically coordinated outreach among all providers within its jurisdiction and recently attended a County Forum on Homelessness that brought together city officials, outreach providers, county officials, consumers and other concerned residents. We recommend organizing outreach teams by region and monthly meetings between operators of Housing Resource Centers to coordinate and case conference at the client level in order to prevent duplication of services. Other coordination strategies include: partnerships with Public Works, Police Departments, Fire Departments, Code Enforcement, and Emergency Medical Services (EMS); using data to organize and schedule outreach; and keeping outreach providers up-to-date on available resources in order to provide the best linkage to care and housing.

*Written by Dr. Kathleen Clanon, Alameda County Care Connect, Medical Director and
Lucy Kasdin and Brightstar Ohlson, Bright Research Group.*

For more information, visit www.accareconnect.org.

AC Care Connect Steering Committee Members

Kathleen Clanon, M.D., Alameda County Care Connect | **Scott Coffin**, Alameda Alliance for Health | **Lori Cox**, Alameda County Social Services Agency | **Elaine de Coligny**, Everyone Home | **Delvecchio Finley**, Alameda Health System | **Linda Gardner**, Alameda County Housing & Community Development | **Colleen Chawla**, Health Care Services Agency | **Beau Hennemann**, Anthem | **John Jones III**, Communities United for Restorative Youth Justice | **Travis Kusman**, Alameda County Emergency Medical Services | **Wendy Peterson**, Senior Services Coalition | **Ralph Silber**, Alameda Health Consortium | **Wendy Still**, Alameda County Probation | **James Wagner**, Alameda County Behavioral Health Care Services

AC Care Connect 4-Year Timeline	Start-up: Jan-Jun 2017	Phase 1 Pilot: Jul 2017-Mar 2018	Phase 2 Pilot: Apr 2018-2019	Scale-up & Sustainability Planning 2019-2020	Wrap-up & Sustainability 2021
--	----------------------------------	--	--	---	--